

enquiry sheet for all system profiles



for system profiles with installation according to abZ Z-70.5.242, abP 400-002-19-1* and abP 40-003-21-2*

Please fill in all fields and mark with a cross where applicable!

contact

company _____

telephone _____

contact _____

e-mail _____

customer no. _____

project/commission _____

(only one balustrade per sheet)

installation location:

indoor



outdoor



installation

according to test certificate (abP)

not relevant

underground

reinforced concrete (strength class): C20/25 C30/37 or better

steel

wood

For static reasons, our systems may only be installed on wooden substrates with a continuous threaded rod and a sufficient counter plate.

floor plans

(please mark) = handrail connected

= handrail not connected

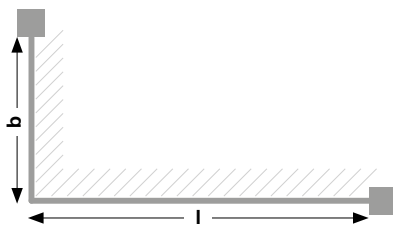

b = left
 b = right

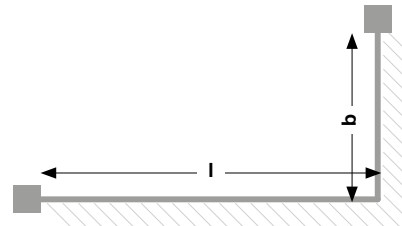

b = left
 b = right

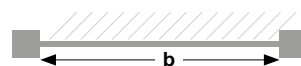
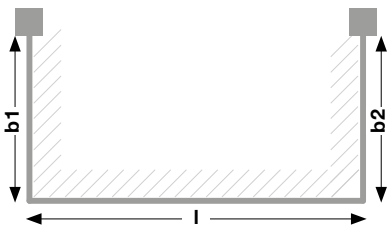

attached sketch:

* If a test certificate expires, a new test certificate number will be assigned.

profile selection and glass type



- cp-1403:
- LSG with FTG* 25,52 mm (abP)



- cp-1442:
- LSG with FTG* 16,76 mm (abP)
- LSG with FTG* 17,52 mm (abP)
- LSG with FTG* 20,76 mm (abP)
- LSG with FTG* 21,52 mm (abP)



- cp-1443:
- LSG with FTG* 16,76 mm (abP)
- LSG with FTG* 17,52 mm (abP)
- LSG with FTG* 20,76 mm (abP)
- LSG with FTG* 21,52 mm (abP)



- cp-1440:
- LSG with FTG* 16,76 mm (abP)
- LSG with FTG* 17,52 mm (abP)
- LSG with FTG* 20,76 mm (abP)
- LSG with FTG* 21,52 mm (abP)



- cp-1444:
- LSG with FTG* 16,76 mm (abP)
- LSG with FTG* 17,52 mm (abP)
- LSG with FTG* 20,76 mm (abP)
- LSG with FTG* 21,52 mm (abP)

* the use of FTG-H is also permissible

desired glass dimensions

rectangular format

parallelogram

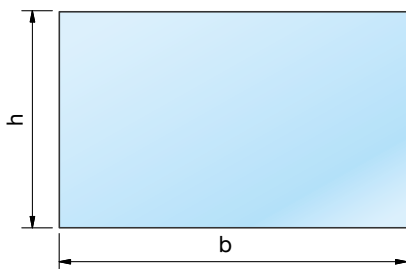

b _____ x h _____ mm
 _____ units

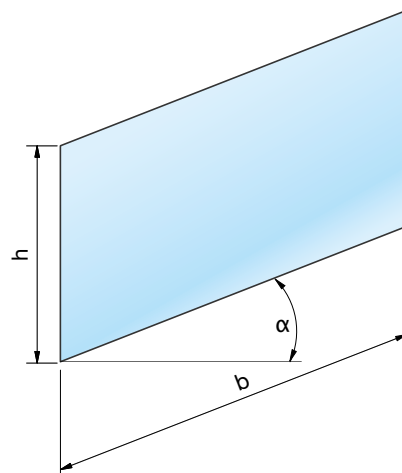

b _____ x h _____ mm
 angle α = _____ °
 _____ units

Note:
 The permitted dimensions can be found in our approval (abZ Z-70.5.242) or test certificates (abP 40-002-19-1 and abP 40-003-21-2).
 A system-static is available on request.

accessories

**rounded slotted tube Ø 42,4 x 1,5mm**
 10242642A2 - length 2500 mm

units

 10242542A2 - length 5000 mm

units

rounded slotted tube Ø 48,3 x 1,5mm
 10242648A2 - length 2500 mm

units

 10242548A2 - length 5000 mm

units

 10242548A4 - length 5000 mm

units

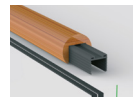
**wooden handrail Ø 42,4 mm,, slotted 24 mm**
 10242942BU - length 2500 mm

Stück

 10242942EI - length 2500 mm

units

**wooden handrail Ø 55 mm, slotted 30 mm for edge protection**
 10242855BU - length 2500 mm

units

 10242855EI - length 2500 mm

units

**edge protection profiles**
 5022VA4-2500 - length 2500 mm (for glass 17,52/21,52 mm)

units

 5022VA4-5M - length 5000 mm (for glass 17,52/21,52 mm)

units

 5029VA4-2500 - length 2500 mm (for glass 25,52 mm)

units

 5029VA4-5M - length 5000 mm (for glass 25,52 mm)

units

**corner welded, for edge protection profiles**
 5022VA4-90H (for glass 17,52/21,52 mm)

units

 5029VA4-90H (for glass 25,52 mm)

units

**spacer gasket for series 140x**

1413EPDM-6 (for glass 17,52 / 21,52 mm)

 6 mm thickness

units

1413EPDM-10 (for glass 17,52 / 21,52 mm)

 10 mm thickness

units

1414EPDM-6 (for glass 25,52 mm)

 6 mm thickness

units

1414EPDM-10 (for glass 25,52 mm)

 10 mm thickness

units

**spacer gasket for series 144x**

1440-20EPDM-6 (for glass 16,76 / 17,52 / 20,76 / 21,52 mm)

 6 mm thickness

units

1440-20EPDM-10 (for glass 16,76 / 17,52 / 20,76 / 21,52 mm)

 10 mm thickness

units

**connecting pin**
 1400-3VA - for 1403

units

 1440-3VA - for series 144x

units

accessories

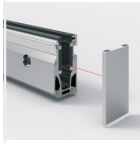

cp-1403
endcap

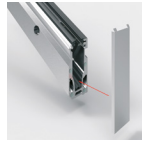

cp-1403
staircase endcap

for cp-1403 - left

1403-11VA4L-25 (for glass 25,52 mm)

un.

for cp-1403 - left

1403-12VA4L-25 (for glass 25,52 mm)

un.

for cp-1403 - right

1403-11VA4R-25 (for glass 25,52 mm)

un.

for cp-1403 - right

1403-12VA4R-25 (for glass 25,52 mm)

un.



profile - inner corner set cp-1403

1426E123-25 (für 25,52 mm Glas)

un.

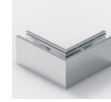

profile - outer corner set cp-1403

1425E123-25 (für 25,52 mm Glas)

un.

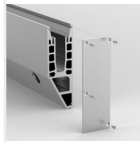

cp-1442
endcap



cp-1442
staircase endcap

for cp-1442 - left

1442-11E123L-17*

un.

for cp-1442- left/ right

1442-12E123-17*

un.

1442-11E123L-21**

un.

1442-12E123-21**

un.

for cp-1442 - right

1442-11E123R-17*

un.

1442-11E123R-21**

un.

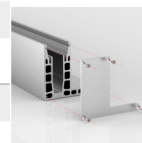

cp-1440
endcap

for cp-1440 - left

1440-11E123L-17*

un.

1440-11E123L-21**

un.

for cp-1440 - right

1440-11E123R-17*

un.

1440-11E123R-21**

un.



cp-1443
endcap

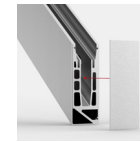

cp-1443
staircase endcap

for cp-1443 - left

1443-11E123L-17*

un.

1443-11E123L-21**

un.

for cp-1443- left/ right

1443-12E123-17*

un.

1443-12E123-21**

un.

for cp-1443 - right

1443-11E123R-17*

un.

1443-11E123R-21**

un.



cp-1444
endcap



cp-1444
staircase endcap

for cp-1443- left/ right

1444-11E123L-17*

un.

1444-11E123L-21**

un.

for cp-1443- left/ right

1444-12E123-17*

un.

1444-12E123-21**

un.

* (für 16,76 / 17,52 mm Glas)
** (für 20,76 / 21,52 mm Glas)

accessories

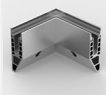

profile - inner corner set cp-1442

1452E123-17*

un. _____

1452E123-21**

un. _____

profile - outer corner set cp-1442

1453E123-17*

un. _____



1453E123-21**

un. _____

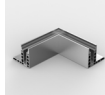

profile - inner corner set cp-1440

1450E123-17*

un. _____

1450E123-21**

un. _____

profile - outer corner set cp-1440

1451E123-17*

un. _____

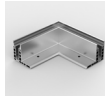

1451E123-21**

un. _____



profile - inner corner set cp-1443

1454E123-17*

un. _____

1454E123-21**

un. _____

profile - outer corner set cp-1443

1455E123-17*

un. _____



1455E123-21**

un. _____

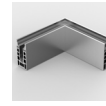

profile - corner set cp-1444

1456E123-17*

un. _____

1456E123-21**

un. _____



shim plate

for 1442 (1402-16VA4-_)

1 mm thickness 3 mm thickness 5 mm thickness

un. _____ un. _____ un. _____

for 1403 and 1443 (1403-16VA4-_)

1 mm thickness 3 mm thickness 5 mm thickness

un. _____ un. _____ un. _____

for 1440 (1400-16VA4-_)

1 mm thickness 3 mm thickness 5 mm thickness

un. _____ un. _____ un. _____

for 1444 (1404-16VA4-_)

1 mm thickness 3 mm thickness 5 mm thickness

un. _____ un. _____ un. _____



consoles

for distance 90 - 110 mm (1435ST8-A)

un. _____

for distance 110 - 150 mm (1435ST8-B)

un. _____

for distance 150 - 220 mm (1435ST8-C)

un. _____

installation location:

Inland: Coast of the North Sea and Baltic Sea and islands of the Baltic Sea North Sea islands

attached name: _____ post code: _____

beam load – categories according to DIN 18008 Cat. B (specification always required)

0,5 kN/m (private) 1,0 kN/m (public) 2,0 kN/m (public) only 1403

effect of wind (information only required for outdoor applications)

characteristic value of the effects

$q_w =$ _____ kN/m²

wind zone 1 wind zone 2 wind zone 3 wind zone 4

The determination of the characteristic value of the effects is to be carried out by P+S.

Due to the new load standard EC1, the determination of the load has become more complicated. This load standard is to be applied for all approvals and all technical rules (i.e., e.g. also DIN 18008). Pauli + Sohn supports you in determining the loads to be applied. We would like to point out that a static proof or a load determination can only be provided by a recognized structural engineer. Therefore, the value determined by P+S is only to be understood as a reference value and is not binding!

building geometry (information always required)

building width: $G_b =$ _____

building depth: $G_t =$ _____

building height: $G_h =$ _____

length of the balustrade: $l =$ _____

width of the balustrade: $b =$ _____

height of the balustrade: $h_g =$ _____

installation height*: $z =$ _____

*from the ground to the top of the balustrade

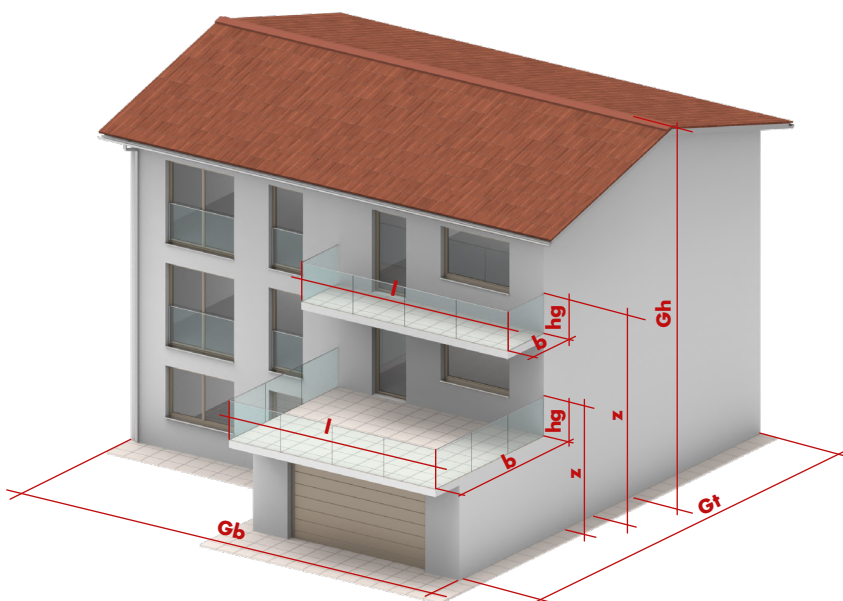
**profile cutting**

yes no

Please mark the required finishing treatment and enter the required values: see on next page!

Zuschnitt – **SYSTEMPROFIL CP-1442**

GLASS THICKNESS:

- 16,76 mm
- 17,52 mm
- 20,76 mm
- 21,52 mm

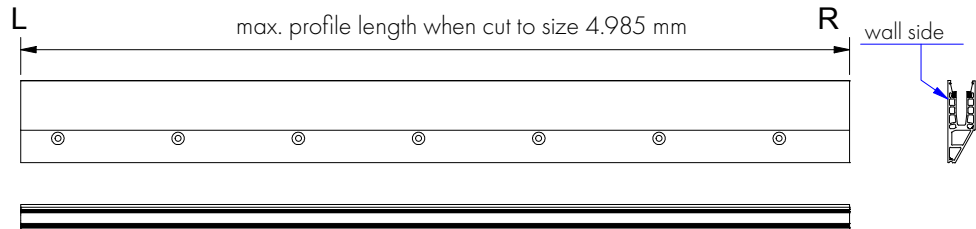

saw blade width = 5 mm

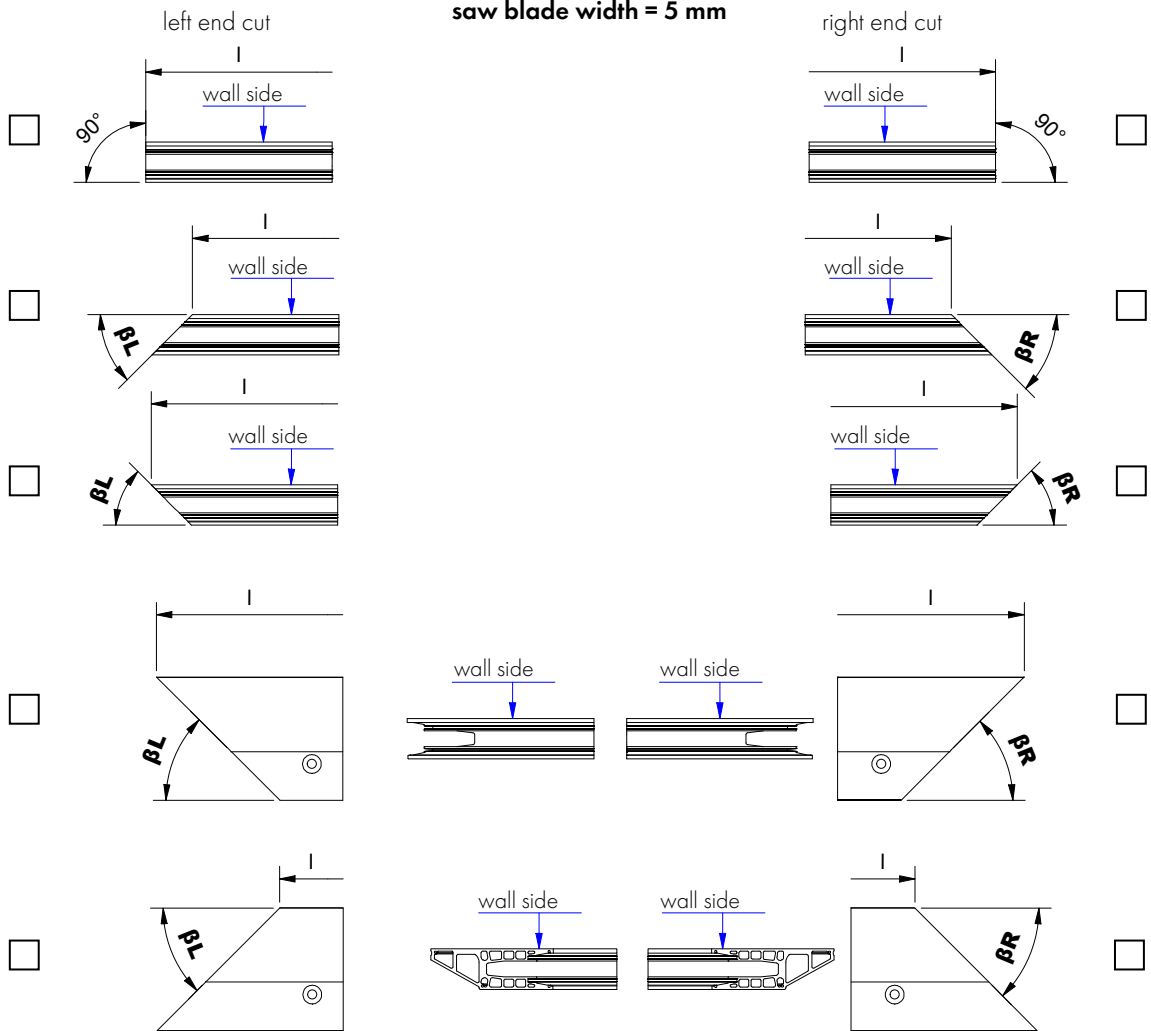

l: _____

βL : _____ quantity: _____

βR : _____ include remains: yes no

Zuschnitt – **SYSTEMPROFIL CP-1443**

GLASS THICKNESS:

- 16,76 mm
- 17,52 mm
- 20,76 mm
- 21,52 mm

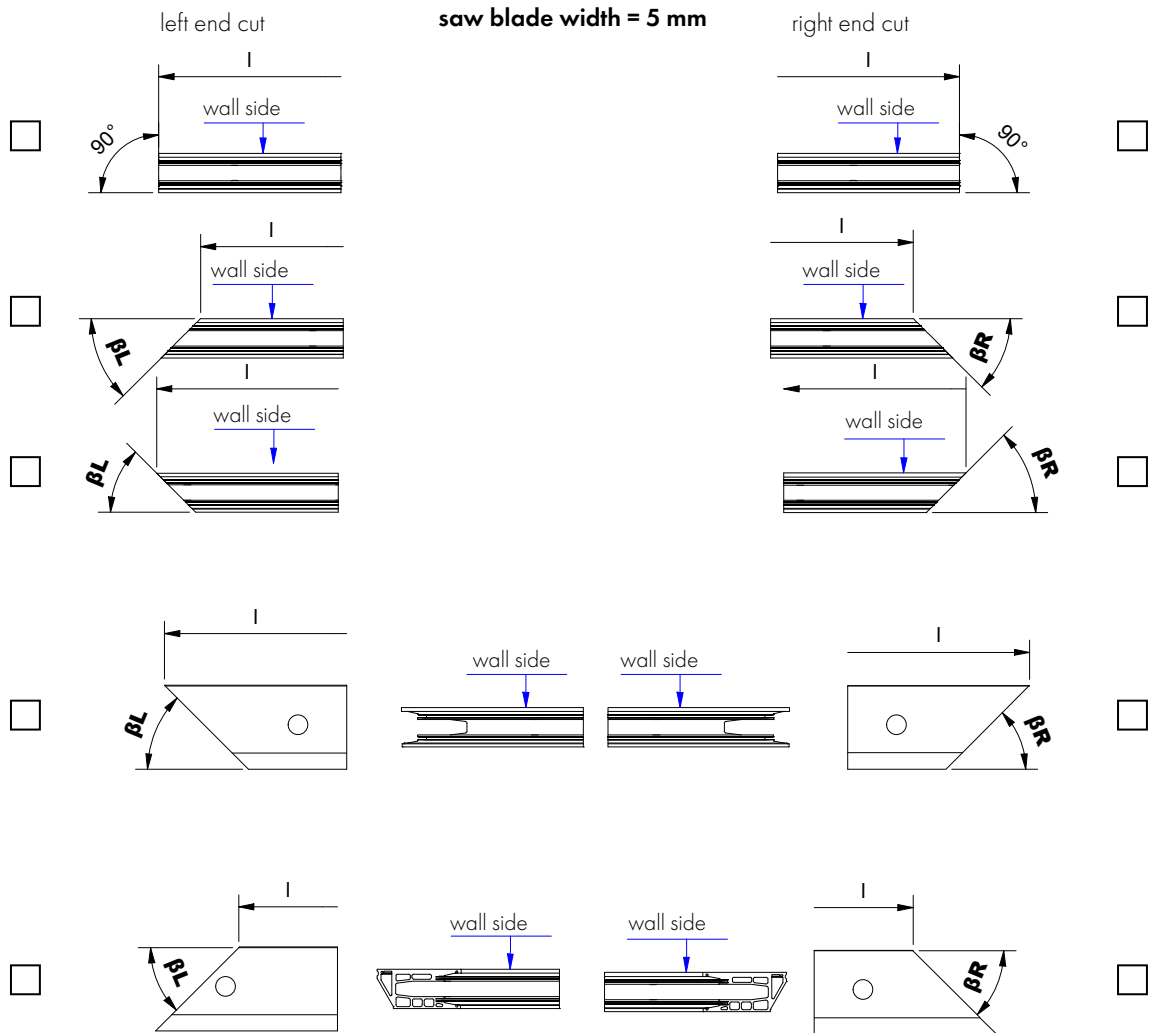
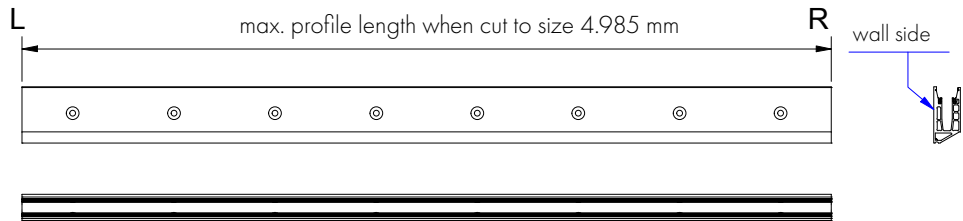

l: _____

βL: _____ quantity: _____

βR: _____ include remains: yes no

Zuschnitt – SYSTEMPROFIL CP-1440

GLASS THICKNESS:

- 16,76 mm
- 17,52 mm
- 20,76 mm
- 21,52 mm

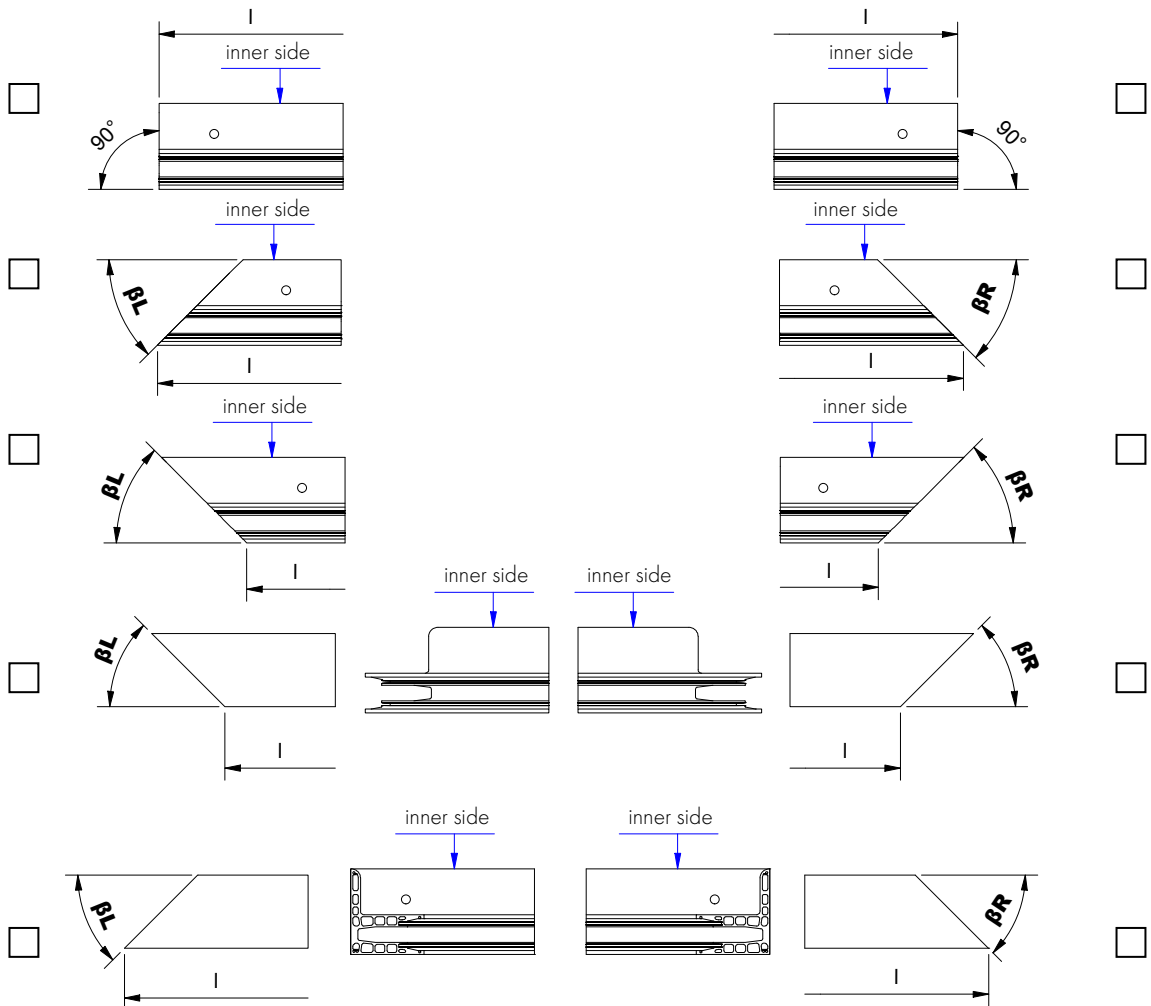
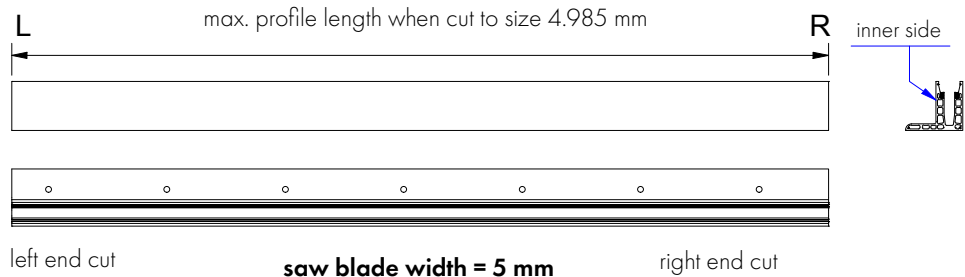

l: _____

βL: _____

βR: _____

quantity: _____

include remains: yes no

Zuschnitt – **SYSTEMPROFIL CP-1444**

GLASS THICKNESS:

- 16,76 mm
- 17,52 mm
- 20,76 mm
- 21,52 mm

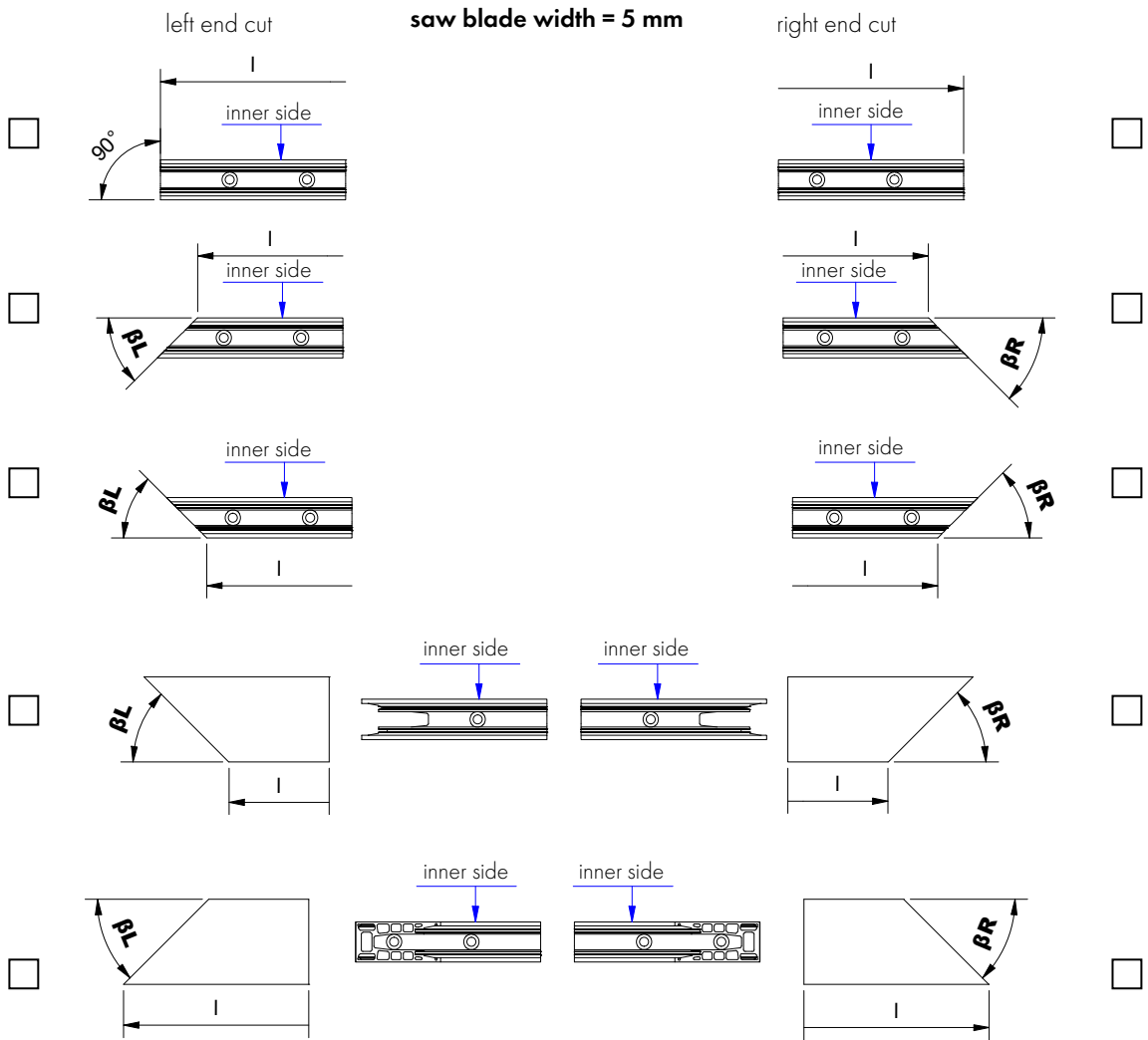
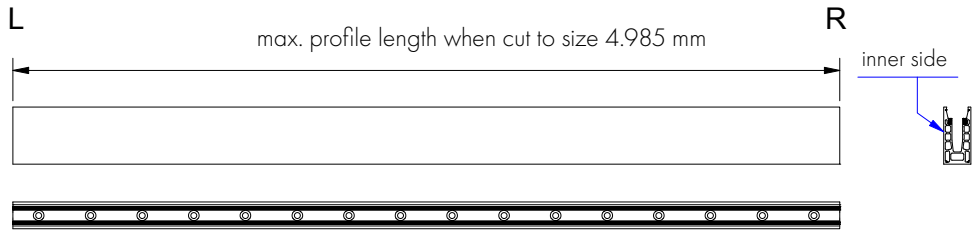

l: _____

βL: _____ quantity: _____

βR: _____ include remains: yes no

Zuschnitt – **SYSTEMPROFIL CP-1403**

GLASS THICKNESS:

25,52 mm

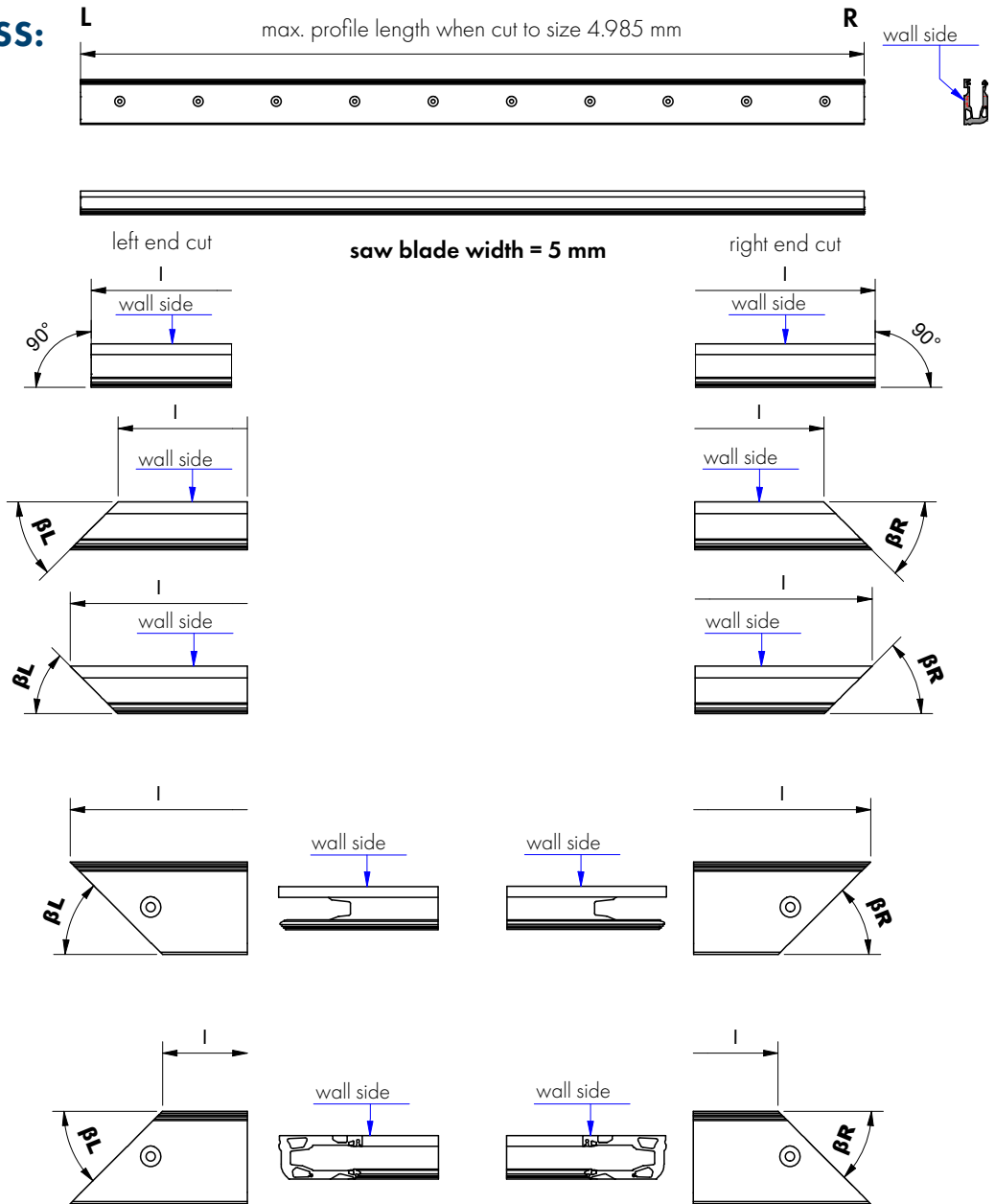

l: _____

βL: _____

βR: _____

quantity: _____

include remains: yes no